

MANUFACTURER & EXPORTER OF PRECISION LATHES



WE ARE AIMING EVEN BETTER.

MICROWEILY

HIGH SPEED PRECISION LATHE

16S/18TS/18 SERIES

Special accessory shown in this picture
is 3-jaw chuck.





• Headstock chuck guard (with safety glass) with micro switch

• Leadscrew and feed rod with protection cover

Halogen work lamp

Fourway tool post with protector

• Electrics and switch with EC approved

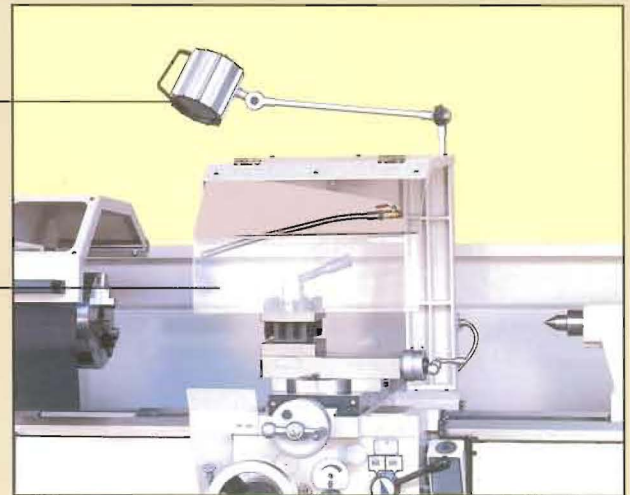

STANDARD ACCESSORIES

- | | |
|-------------------------------------|---|
| 1. Center sleeve No.6/No.4 MT | 12. Automatic stop for longitudinal feeds |
| 2. 2 Centers, No.4 MT | 13. Motor: 7-1/2HP, 3ph for 1845S/1868 |
| 3. Tool box, tool kits & grease gun | 14. Motor: 5HP, 3ph for 16S/18TS |
| 4. Tool turret wrench | 15. Coolant pump equipment |
| 5. Thread dial indicator | 16. Instruction & parts manual |
| 6. Chip tray for TY-1868 | |
| 7. Installation block | |
| 8. Safety pin | |
| 9. Safety fuses | |
| 10. Repair paint | |
| 11. Back plate | |

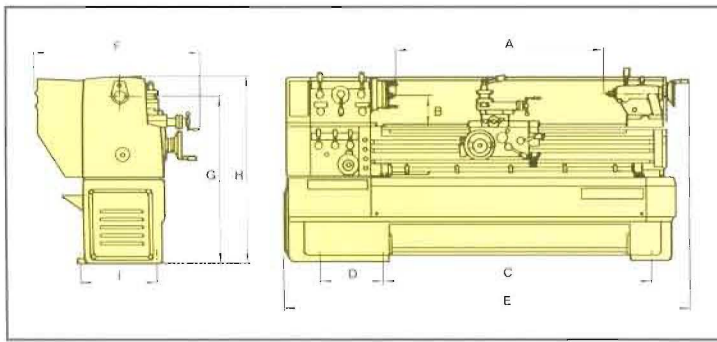

A: 762mm (30")/16S/18TS
 1016mm (40")/16S/18TS
 1530mm (60")/16S/18TS
 1145mm (45")/1845

E: 1986mm (78-3/16")/16S/18TS
 2240mm (88-1/4")/16S/18TS
 2755mm (108-7/16")/16S/18TS
 2435mm (95-7/8")/1845

B: 205mm (8-1/16")/16S
 230mm (9")/18TS
 215mm (8-15/32")/18

F: 1077mm (42-3/8")

C: 1058mm (41-5/8")/16S/18TS
 1312mm (51-21/32")/16S/18TS
 1827mm (71-15/16")/16S/18TS
 1495mm (58-27/32")/1845

G: 1080mm (42-1/2")/16S
 1105mm (43-1/2")/18TS/18

H: 1205mm (47-1/2")/16S
 1230mm (48-7/16")/18TS/18

I: 500mm (19-21/32")

D: 400mm (15-3/4")

SPECIFICATION

SERIES		16S	18TS	18
MODEL		1630S/1640S/1660S	1830TS/1840TS/1860TS	1845S
CAPACITY & DIMENSIONS	Swing over bed	410mm (16")	458mm (18")	
	Swing over cross slide	240mm (9-7/16")	288mm (11-5/16")	
	Swing in gap diameter	595mm (23-7/16")	640mm (25-3/16")	
	Length of gap in front of face plate	155mm (6-1/8") (W/D1-6) 175mm (6-7/8") (W/A1-6)		180mm (7-1/16") (W/D1-6) 195mm (7-11/16") (W/A1-6)
	Center height	205mm (8-1/16")	230mm (9")	
	Center admits between	762mm (30")/1016mm (40")/1530mm (60")		1145mm (45")
	Bed width	300mm (11-13/16")		
	Bed length	1646mm (64-13/16")/1900mm (74-3/4")/2415mm (95-1/16")		2095mm (82-1/2")
	Bed height	310mm (12-7/32")		340mm (13-3/8")
	Motor for main spindle	5HP 4P 3Ph / 7-1/2HP 4P 3Ph (Optional)		7-1/2HP 4P 3Ph
Motor for coolant pump	1/8HP 2P 3Ph			
HEADSTOCK	Spindle bore	52mm (2-1/16")	60mm (2-3/8")	58mm (2-1/4")
	Spindle nose	D1-6" ASA Std., A1-6" ISO Std.		
	Spindle taper in nose/sleeve	No.6/No.4		
	Speeds number	12		
	Speeds range	30-2000 r.p.m.		
CARRIAGE & COMPOUND	Cross slide width/travel	180mm (7-3/32")/230mm (9")		190mm (7-1/2")/265mm (10-7/16")
	Compound rest width/travel	110mm (4-11/32")/120mm (4-3/4")	125mm (4-15/16")/135mm (5-5/16")	
	Leadscrew diameter & thread	32mm (1-1/4")/6mm P or 4 T.P.I.		35mm (1-3/8")/6mm P or 4 T.P.I.
THREADS & FEEDS	Imperial pitches	40 Nos. 2-56 T.P.I.		60 Nos. 2-112 T.P.I.
	Metric pitches	53 Nos. 0.4-14mm Pitch		60 Nos. 0.2-14mm Pitch
	Diametral pitches	32 Nos. 4-32 D.P. (Optional)		50 Nos. 4-112 D.P. (Optional)
	Module pitches	44 Nos. 0.4-7 M.P. (Optional)		50 Nos. 0.2-7 M.P. (Optional)
	Cross feeds	Imperial 40 Nos. 0.0006"-0.0126"/rev. Metric 40 Nos. 0.016mm-0.449mm/rev.	50 Nos. 0.0007"-0.01935"/rev. 50 Nos. 0.0185mm-0.52mm/rev.	
TAILSTOCK	Longitudinal feeds	Imperial 40 Nos. 0.0012"-0.0252"/rev. Metric 40 Nos. 0.032mm-0.898mm/rev.	50 Nos. 0.0014"-0.0387"/rev. 50 Nos. 0.037mm-1.04mm/rev.	
	Quill diameter/travel	54mm (2-1/8")/120mm (4-3/4")		60mm (2-3/8")/150mm (5-7/8")
	Quill taper	No.4 Morse		
WEIGHT & MEASURES (APPROX.)	Machine length	1986mm (78-3/16")/2240mm (88-1/4")/2755mm (108-7/16")		2435mm (95-7/8")
	Machine width	980mm (38-5/8")		
	Machine height	1205mm (47-1/2")	1230mm (48-7/16")	
	Packing dimensions	81"x44"x65"/91"x44"x65"/112"x44"x65"		98"x44"x65"
	Net weight	1575Kgs/1750Kgs/2000Kgs		1810Kgs
	Gross weight	1800Kgs/2000Kgs/2300Kgs		2160Kgs

* Design and specifications are subject to change without notice.



WE ARE AIMING EVEN BETTER.

MICROWEILY

WEY YII CORP.

409-6 PEI-TON ROAD, PEI-TON DIST., 406
 P.O. BOX 901, TAICHUNG, TAIWAN, R.O.C.
 TEL: 886-4-22447999
 FAX: 886-4-22444555, 22448555
 E-Mail: b139@ms17.hinet.net
 http://www.microweily.com.tw